

Electrolstatic discharge Protection Devices(ESD)

FEATURES

- Low Leakage Current
- Bi-direction high reliability

MECHANICAL DATA

- Case style:SOD-882 molded plastic
- Polarity:color band denotes positive end
(cathode) except for bidirectional
- Mounting position:any

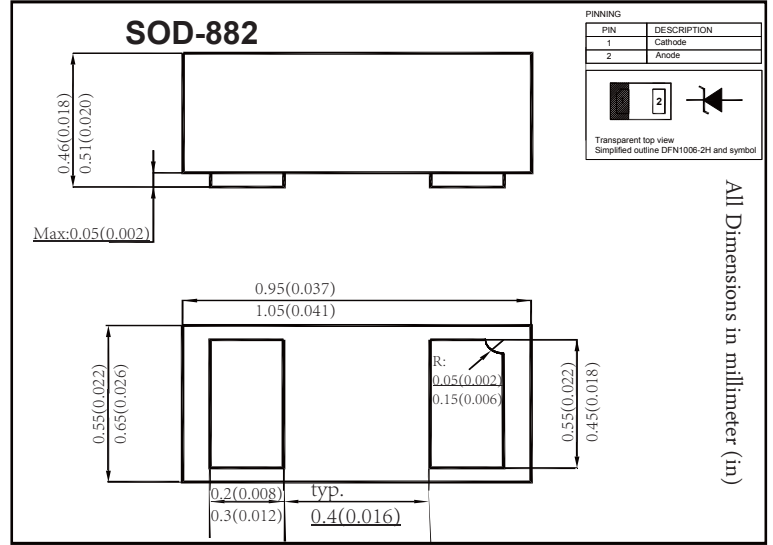

MAXIMUM RATINGS AND CHARACTERISTICS

@ 25°C Ambient Temperature (unless otherwise noted)

Absolute Maximum Ratings (T_a = 25°C)

Parameter	Symbol	Value	Unit
IEC61000-4-2 (ESD) Contact	-	± 30	KV
Power Dissipation on FR-5 Board ¹⁾	P _D	150	mW
Junction Temperature	T _j	- 55 to + 150	°C
Storage Temperature Range	T _{stg}	- 55 to + 150	°C

¹⁾FR-5 = 1.0 x 0.75 x 0.62 in

Characteristics at T_a = 25°C(V_F = 0.9 V Max. at I_F = 10 mA)

Type	Marking Code	Reverse Stand-off Voltage	Reverse Current	Breakdown Voltage		Clamping Voltage	Reverse Peak Pulse Current	Peak Power Dissipation	Capacitance		
		V _{RWM}	I _R at V _{RWM}	V _{BR}	at I _T	V _C at Max.I _{PP}	I _{PP}	P _{PK} (W) 8X20 μS	C _j	at f	at V _R
		Max. (V)	Max. (μA)	Min. (V)	(mA)	Max. (V)	Max. (A)	Typ	Typ. (pF)	(MHz)	(V)
ESD9P3V3	XA	3.3	2.5	5	1	10.4	9.8	102	80	1	0
ESD9P5V0	XB	5	1	6.2	1	12.3	8.7	107	65	1	0
ESD9P12	XC	12	1	13.5	1	23.7	5.9	140	30	1	0

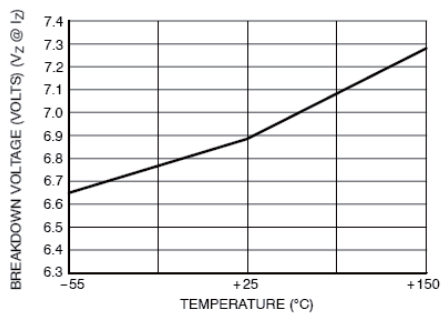

Figure 1. Typical Breakdown Voltage versus Temperature

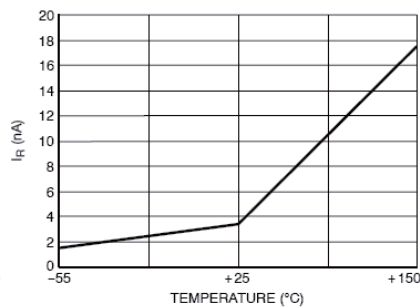

Figure 2. Typical Leakage Current versus Temperature