

## Small Signal Switching Diodes

**VOLTAGE RANGE: 75V**  
**PEAK PULSE POWER: 350mW**

### Features

- Ultra small mold type
- High reliability.
- High speed switching

### MECHANICAL DATA

- Case: SOT-23 Small Outline Plastic Package
- Polarity: Color band denotes cathode end
- Mounting Position: Any

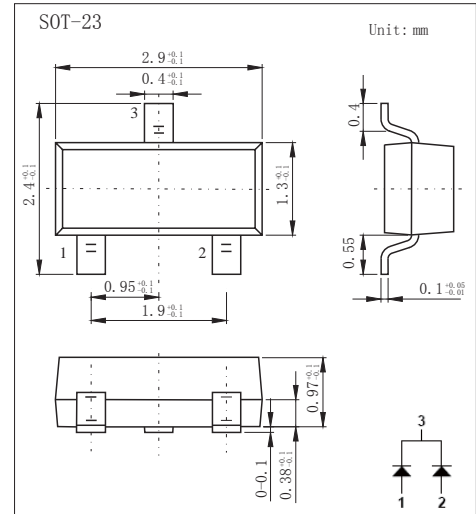

## MAXIMUM RATINGS AND CHARACTERISTICS

@ 25°C Ambient Temperature (unless otherwise noted)

Parameter	Symbol	Rating	Unit
Maximum Repetitive Reverse Voltage	V <sub>RRM</sub>	75	V
Average Rectified Forward Current	I <sub>F(AV)</sub>	200	mA
Non-repetitive Peak Forward Surge Current	I <sub>FSM</sub>	1.0	A
Pulse Width = 1.0 second		2.0	A
Pulse Width = 1.0 microsecond			
Power Dissipation	P <sub>D</sub>	350	mW
Thermal Resistance, Junction to Ambient	R <sub>θJA</sub>	357	°C/W
Storage Temperature Range	T <sub>stg</sub>	-55 to +150	°C
Operating Junction Temperature	T <sub>J</sub>	-55 to +150	°C

## Electrical Specification (T<sub>A</sub>=25°C unless otherwise specified)

Parameter	Symbol	Testconditions	Min	Typ	Max	Unit
Breakdown Voltage	V <sub>R</sub>	I <sub>R</sub> = 100 μA	75			V
Forward Voltage	V <sub>F</sub>	I <sub>F</sub> = 50 mA			1.0	V
		I <sub>F</sub> = 100 mA			1.2	V
Reverse Current	I <sub>R</sub>	V <sub>R</sub> = 50 V			100	nA
Total Capacitance	C <sub>T</sub>	V <sub>R</sub> = 0, f = 1.0 MHz			4.0	pF
Reverse Recovery Time	t <sub>rr</sub>	I <sub>F</sub> = I <sub>R</sub> = 10 mA, I <sub>RR</sub> = 1.0 mA, R <sub>L</sub> = 100 Ω			4.0	ns

### Marking

Marking	A6
---------	----